

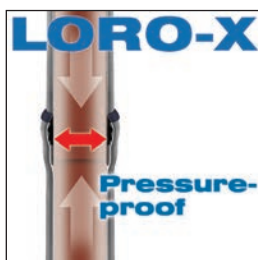

LORO-X Rain standpipes

Advantages:

- Corrosion protection through hot-dip galvanising
- Nominal diameters from DN 50 to DN150 and lengths from 500 mm to 3000 mm
- Backflow-safe through LORO-X push-fit socket with sealing element
- Special renovation standpipes
- Extensive range of fittings and supports
- Transitions pieces to all common underground pipes
- Externally supervised and certified to DIN EN ISO 9001: 2008



Sturdy:

LORO-X rain standpipes and rainwater downpipes for every façade



LORO-X rain standpipes and rainwater downpipes with a LORO-X parapet drainage



LORO-X rain standpipes without clean-out opening with pipe offset into the underground pipe



LORO-X rain standpipes for renovation



LORO-X rain standpipes with high-performance safety overflow



LORO-X rain standpipes and rainwater downpipes in residential construction



LORO-X rain standpipes and rainwater downpipes with pipe offset

LORO-X rain standpipes and rainwater downpipes, secure and versatile

Rainwater downpipes are at risk of mechanical damage on residential buildings, inside and outside industrial buildings, on public buildings and multi-storey car parks and in the vicinity of paths and roads up to a height of 3 metres.

This damage not only looks unaesthetic, it can also lead in the long run to unwanted moisture penetration into masonry and facades.

LORO-X rain standpipes and rainwater downpipes made of hot-dip galvanized steel, copper or stainless steel offer a high degree of security through high wall thicknesses and the proven backflow-safe socket joint.

With a versatile range of pipes and fittings, LORO rain standpipes and rainwater downpipes can be integrated into the pipe layout in modern façade design. Deviations of the layout such as bases or subsequently attached thermal insulation very often have to be compensated.

The extensive range of pipes and fittings of the LORO-X rain standpipes and rainwater downpipes is ideal for this with offset pipes, bends, branches and transitions. In addition, the backflow-safe LORO-X push-fit socket connection ensures simple installation.



Versatile range of LORO-X pipes, fittings and supports

Tested safety

Supervision

The manufacturing supervision for pipes and fittings is performed by TÜV Rheinland LGA Products GmbH in Würzburg and for sealing elements by the State Materials Testing Office of North Rhine-Westphalia in Dortmund (external supervision). LORO is certified according to DIN EN ISO 9001: 2015 and a member of the GET professional association/RAL quality association.

Backflow safety

The tightness values of the LORO-X push-fit socket connection lie above the requirement of DIN 1986 Part 100:2016 (internal and external overpressure 0 – 0.5 bar) for all nominal diameters.

Fire behaviour

According to DIN 4102, LORO rain standpipes and rainwater downpipes are to be assigned to building material class A 1, incombustible, and are classified as incombustible according to DIN 1986, Part 4.



LORO-X rain standpipes for the renovation of rainwater downpipes

with discharge end for transition to SML/KG discharge pipes

- 1) Rainwater downpipe to be repaired with underground pipe made of cast iron or plastic
- 2) Shorten the underground pipe with a saw or angle grinder
- 3) Deburr the cut underground pipe
- 4) Place the CV/CE sealing on the sawn-off end of the pipe and insert the LORO rain standpipe into the CV/CE sealing
- 5) Attach the CV/CE connector
- 6) Repaired rainwater downpipe



No negative effects on the underground pipe!

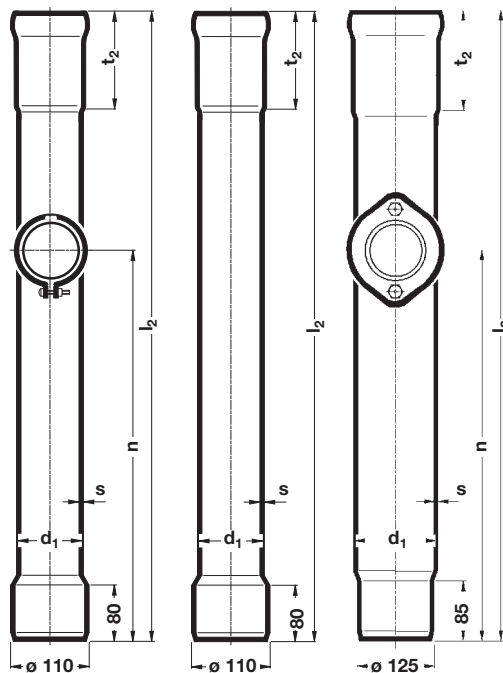

Rain standpipes as renovation standpipe with clean-out opening made of steel, round

Item no.	DN	Outlet	l ₂	d ₁	t ₂	n	s	kg
05559.100X	100	110	500	102	150	250	1.8	2.8
05554.100X	100	110	1000	102	150	620	1.8	5.3
05557.100X	100	110	2000	102	150	620	1.8	10.4
05554.125X	125	125	1000	133	160	620	2.5	8.5

Rain standpipes as renovation standpipe without clean-out opening made of steel, round

Item no.	DN	Outlet	l ₂	d ₁	t ₂	s	kg
05553.100X	100	110	1000	102	150	5.1	2.8

Supply lengths 500 mm and 2000 mm on request.

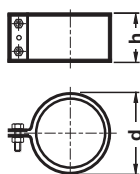

CV connector for renovation standpipes DN 100

Item no.	DN	d	h	kg
09070.100X	100	121	54	0.21

Please order the sealing elements separately

LORO-X HSÜ rain standpipes with high-performance safety overflow

LORO-X rain standpipes with HSÜ high-performance safety overflow offer increased protection against backflow from the underground pipe in the downpipe of the main drainage.

Drainage takes place via the patented HSÜ safety overflow in the clean-out opening onto surfaces that can be flooded without causing damage.

- High-performance backflow protection
- Suitable for all exterior downpipes
- Suitable for new buildings and for renovation
- Discharge rate of up to 9 l/s (DN 100)

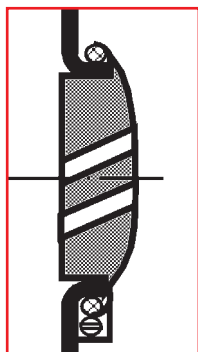
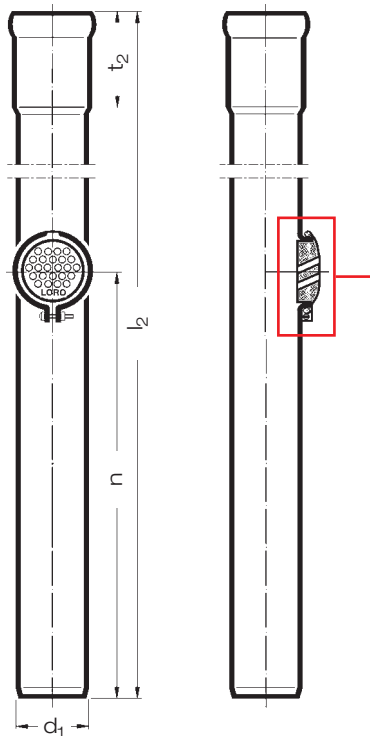

with pipe-like drain openings

Item no.	DN	l_2	d_1	t_2	n	kg
55154.100X	100	1500	102	150	620	6,6
55154.150X	150	1500	159	170	620	14,2
55204.100X	100	2000	102	150	620	7,5
55204.125X	125	2000	133	160	620	18,5

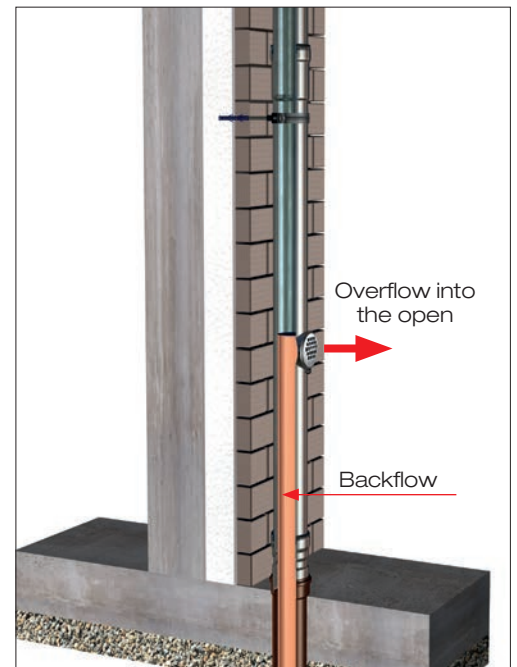

Please order the sealing elements separately

LORO-rain standpipes. The safe solution for modern façade design.

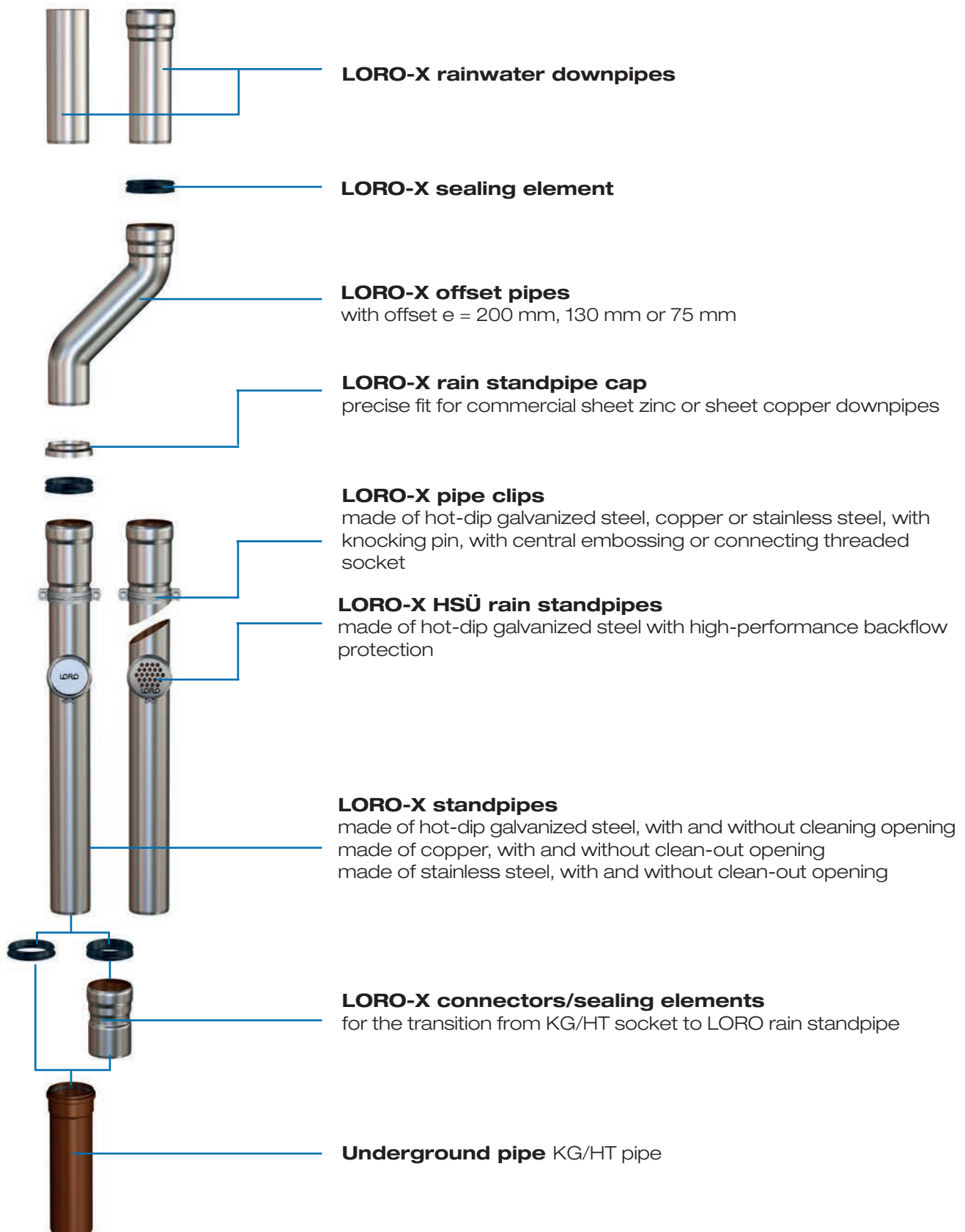

Transitions from LORO-X pipe to KG socket

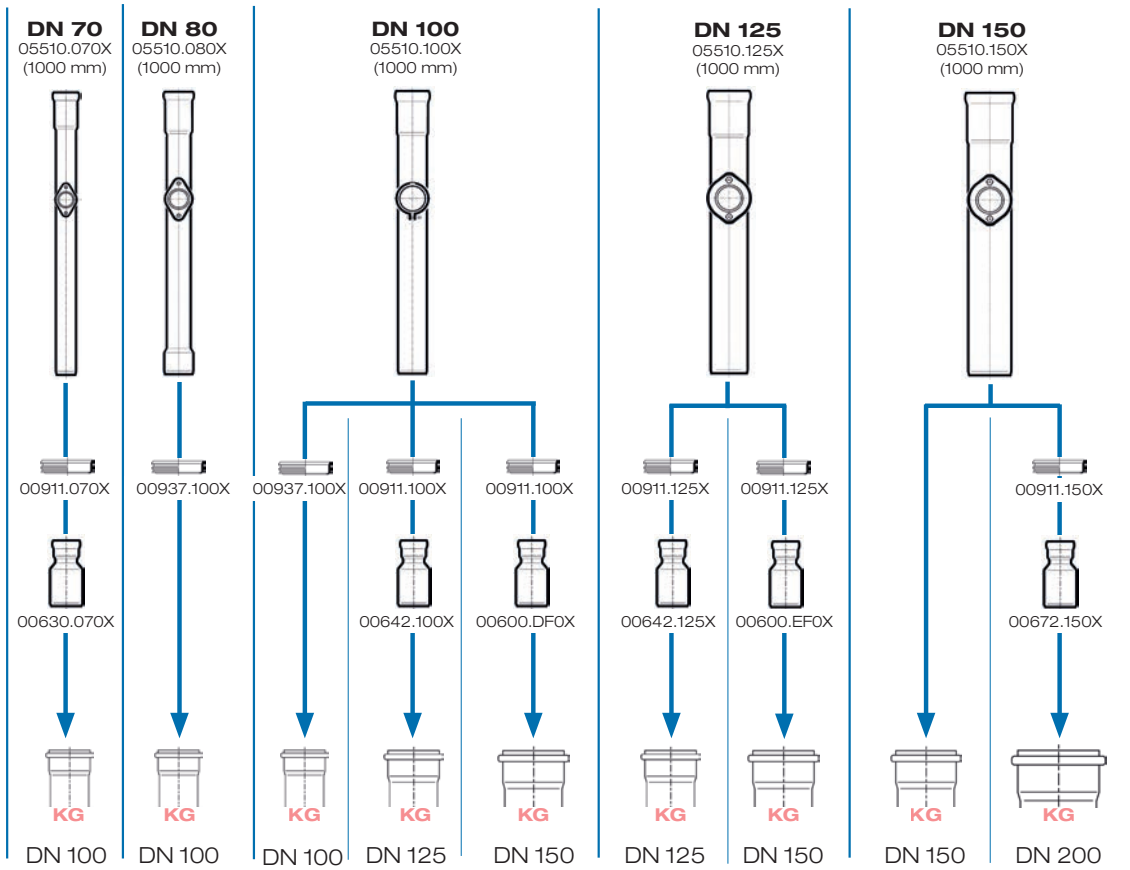

Transitions from LORO-X pipe to SML pipe

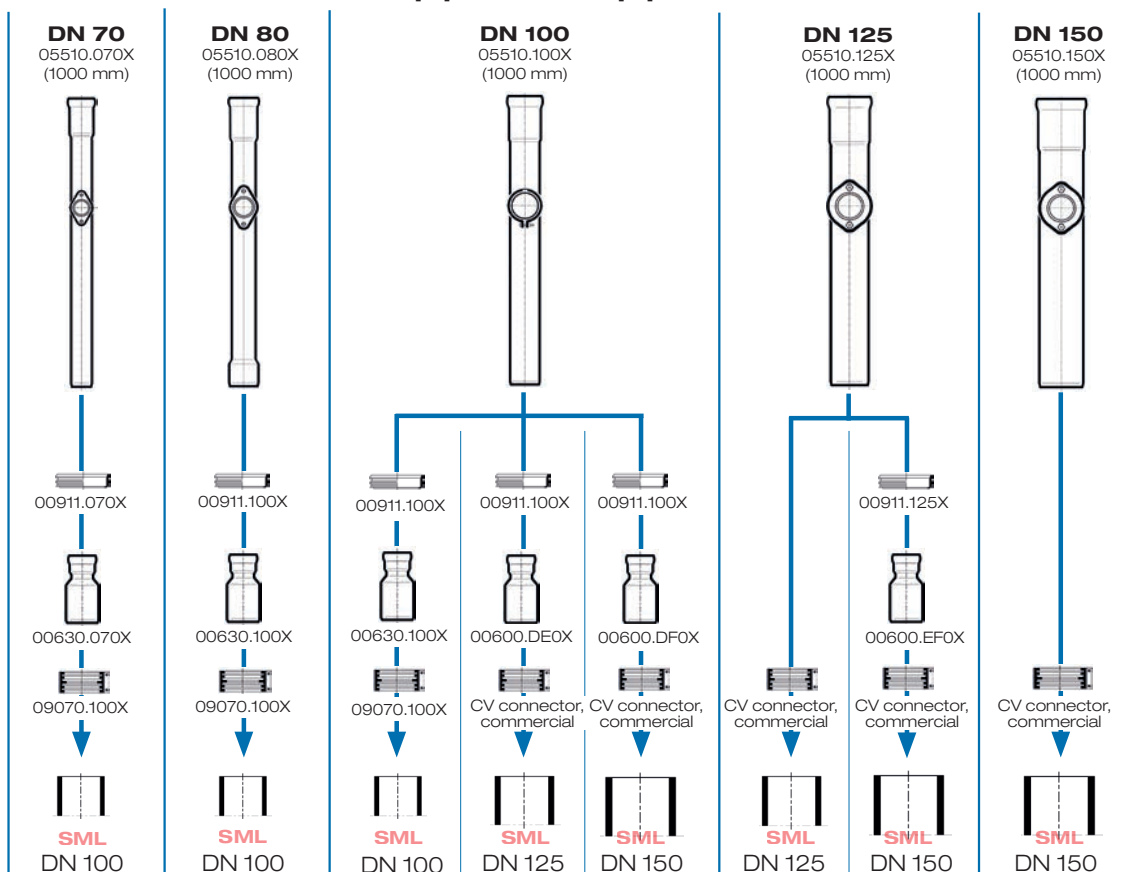



LOROWERK K.H. Vahlbrauk GmbH & Co. KG

Kriegerweg 1 • 37581 Bad Gandersheim, Postfach 1380 • 37577 Bad Gandersheim • Germany
Tel. +49 5382 71 0 • Fax +49 5382 71 203 • Internet: www.loro-x.com • e-mail: infocenter@lorowerk.de